

Recommended PCB Layout
(Bottom View)

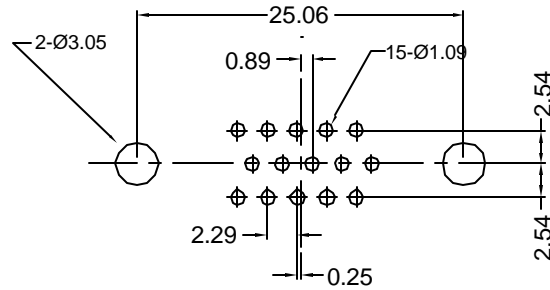

Part Number	Contact Area Plating Finish
K66X-E15S-N	Gold Flash (standard)
K66X-E15S-N15	15u" Gold (-15 option)
K66X-E15S-N30	30u" Gold (-30 option)

Material and Finish

Shell: steel, zinc plated or tin plated

Insulator: PBT with glass-fiber reinforcement, UL 94V-0 rated, black color

Contact Material:

Socket - phosphor bronze

Contact Plating Options:

Standard:

gold flash on contact area, tin on termination end, with entire contact nickel underplated

-15 Option:

15u" gold on contact area, tin on termination end, with entire contact nickel underplated

-30 Option:

30u" gold on contact area, tin on termination end, with entire contact nickel underplated

Electrical Specifications

Rated Current:
5A

Dielectric Withstanding Voltage:
1000V AC (rms) min.

Insulation Resistance:
more than 1000 Megohm at 500V DC

Contact Resistance:
13 milliohm max.

Operating Temperature:
-55°C to +105°C

Durability:
500 mating cycles min.



Tolerances
X.X ± 0.25
X.XX ± 0.15
Unless Stated Otherwise

REV.	DATE	DESCRIPTION	REV. BY	CHK. BY	DRAWN BY	DATE
A1	7/19/05	New Drawing	R. Aguirre	H. MA	R. Aguirre	07/18/05

K66X-E15S-N

R. Ang HD D-Sub, RoHS Compliant

0.350" Footprint, Female

